

# SB42x36-SSB-LC

## 42" X 36" STANDARD SHOWER BASE WITH CENTER DRAIN IMI LITECAST™

Note: Base dimensions may vary +/- 1/4"

\* Also available in IMI ProCast™



### FEATURES

- Shower base size: 42" x 36"
- Curb size: 4" x 4 1/2"
- Construction:
  - \* Solid one piece
  - \* Pre-leveled
  - \* Rests on the subfloor
  - \* Grout-free
  - \* Non-porous
  - \* Water & Leak-proof
- Resistant to:
  - \* Bacteria
  - \* Mold and mildew
  - \* Stains (easy to clean)
- Flange: Industrial composite (attached in our factory)

### STANDARDS AND RATINGS

- Typical CSI Code: 22 42 23 (Div 22)
- Complies with ANSI Z124 Test
- Complies with ASTM F 462 (Anti-slip test), Our lowest value read was 0.07, test requires 0.04
- MAS Certified Green
- ASTM (Fire rating)

Code compliant when fully equipped and installed according to guidelines.

Material to be crated and stacked on pallets.



Cast Marble Solutions

#### COLOR & TRIM OPTIONS

| Standard Color | Code |
|----------------|------|
| White          | SW   |
| Optional Color | Code |
| Cream          | SC   |
| Ivory          | SI   |
| Warm White     | WW   |



**SB42x36-SSB-LC**

42" X 36" STANDARD SHOWER BASE WITH CENTER DRAIN

IMI LITECAST™

Top View

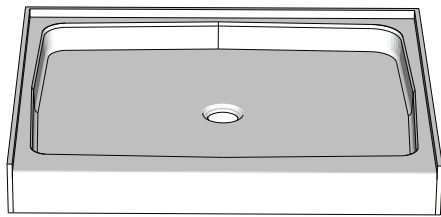
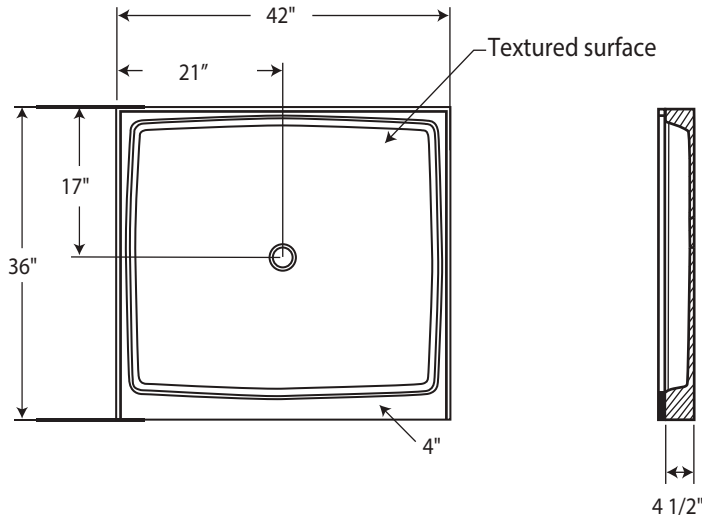

Flange Details: (U.S.)

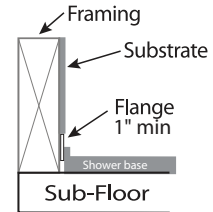

Drain Details: (U.S.)

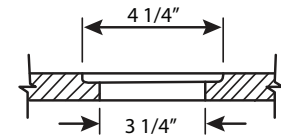

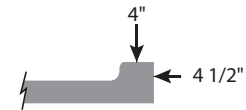

Side View of Curb



**FEATURES:** Dimensional Tolerance  $\pm 1/4"$ . Dimensions needed for site preparation should be measured from the unit. American Bath Group assumes no responsibility for preparatory work.

| Type and Model #            | Material    | Shower Base               | Pieces |
|-----------------------------|-------------|---------------------------|--------|
| Shower Base #SB42x36-SSB-LC | Cast Marble | Anti-Slip/Textured Finish | 1      |

SUGGESTED DRAINS

| Image   | Description   |
|---|---|
|  | Solvent Weld type fitting similar to Oatey Part No. 42097           |
|  | Compression type "No-Caulk" fitting similar to Oatey Part No. 42099 |

Drains are not sold by IMI

Rev. 02.24