

SB84x36-ADJ-CUSTOM-TD

inches

84 X 36 ADJUSTABLE SHOWER BASE WITH LH OR RH TRENCH DRAIN IMI LITECAST™

Exterior Dimensions: 84W x 36D

Note: Base dimensions may vary +/- 1/8"

* Also available in IMI ProCast™



Material to be stacked on pallets.

DRAIN FINISHES

Solid Cover	Code
Brushed Stainless Steel	SS
Ornamental (Slotted)	OSS
Decorative (Perforated)	DSS
Powder Coated	W, MB

COLOR & TRIM OPTIONS

Standard Color	Code
White	SW

Optional Color	Code
Cream	SC
Ivory	SI
Warm White	WW

Additional custom colors available.



Cast Marble Solutions

FEATURES

- Available in Left Hand and Right Hand version
- Customizable to your specifications with fiberglass flange
- Solid one-piece construction, including fiberglass flanges, **chemically bonded to base** (upon request)
- Curb attached by plant or in field
- Pre-sloped to the drain, rests on subfloor
- Mold and mildew resistant
- Bacteria resistant
- "Grout-free" and non-porous
- Stain resistant and easy to clean
- Waterproof and leakproof

STANDARDS AND RATINGS

- Typical CSI Code: 22 42 23 (Div 22)
- ANSI
- ASTM (Fire Rating)
- MAS Certified Green

Code compliant when fully equipped and installed according to guidelines.



SB84x36-ADJ-CUSTOM-TD

84 X 36 ADJUSTABLE SHOWER BASE WITH LH OR RH TRENCH DRAIN

IMI LITECAST™

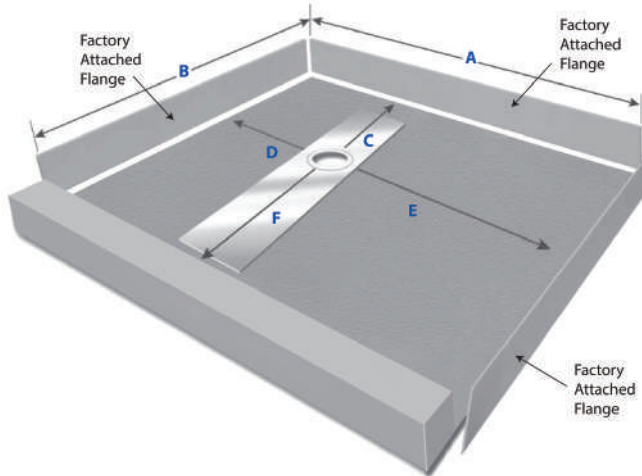

Dimensions:

- A** = 84" max.
- B** = 36" max. (w/a curb 38")

Drain Location:

- C** = 26.5" max. / 8" min.
- D** = 12" max. / 3.5" min.
- E** = 54" max. / 3.5" min.
- F** = 26.5" max. / 8" min.

Curb Cross-Section View:

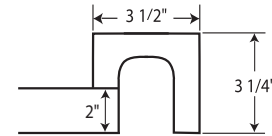

Flange Details: (U.S.)

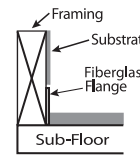

Drain Details: (U.S.)

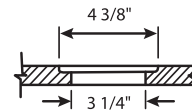

FEATURES Dimensional Tolerance $\pm 1/8"$. Dimensions needed for site preparation should be measured from the unit. American Bath Group assumes no responsibility for preparatory work.

Type and Model #	Material	Shower Base	Pieces
Shower Base #SB84x36-ADJ-CUSTOM-TD	Cast Marble	Anti-Slip/Textured Finish	1

DIMENSIONS

Specifications	inches
Shower Base Depth:	36 max / 38 max with curb
Shower Base Width:	84 max
Curb Height:	3
Curb Width:	3

Suggested Drains:



Solvent Weld type fitting similar to Oatey Part No. 42097



Compression type "No-Caulk" fitting similar to Oatey Part No. 42099

Rev. 12.17.20